

A B C D E F G H

FRONT VIEW

RIGHT SIDE VIEW

ADD OR REPLACE -MM WITH
 -61 TO DRAWING FOR ANSI 61 FINISH
 -49 TO DRAWING FOR ANSI 49 FINISH
 -70 TO DRAWING FOR ANSI 70 FINISH
 -MG TO DRAWING FOR MILL GALVANIZED STEEL
 -SS TO DRAWING FOR 304 STAINLESS
 -AL TO DRAWING FOR ALUMINUM

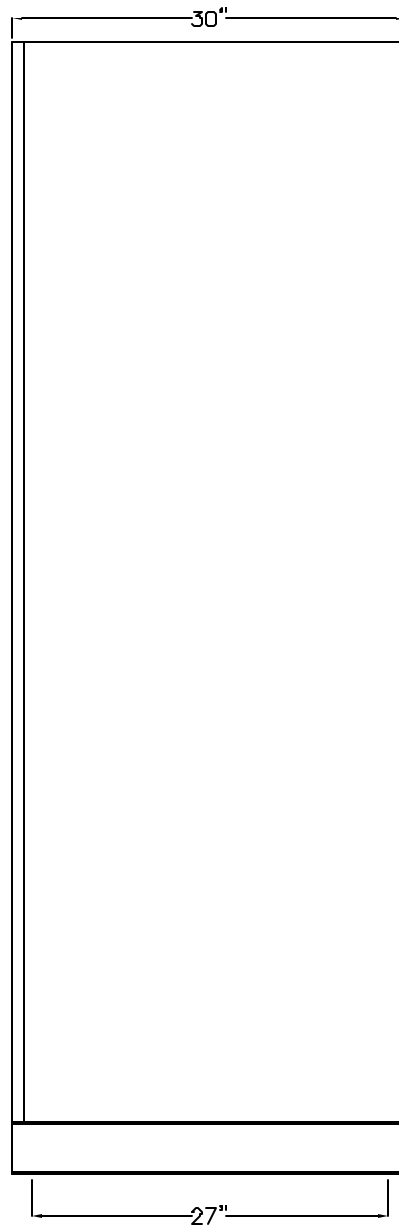
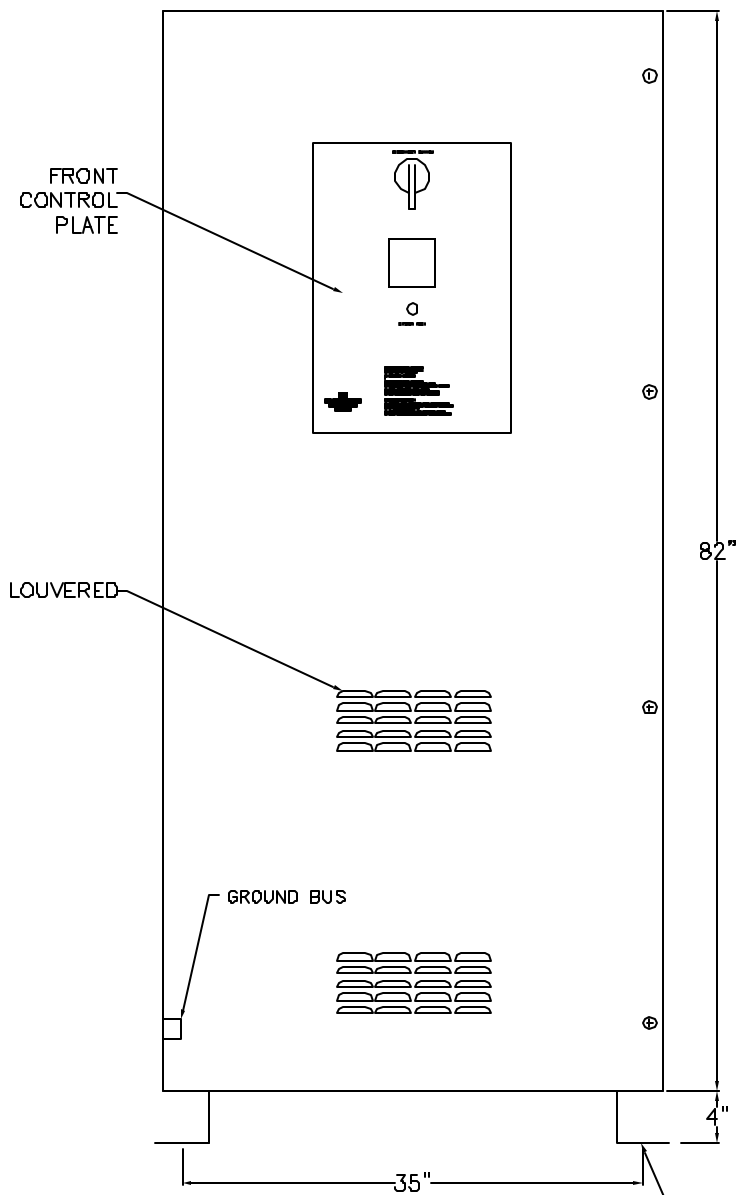

(4) 1 1/8" X 5/8" SLOTS

FLOOR MOUNTED ENCLOSURE 38"W x 30"D x 86"H
 BOLT HOLE PATTERN: 35" X 27"

PG Post Glover Resistors
 4750 Olympic Blvd Erlanger, KY USA 41018
 Phone: 800.537.6144 / 859.283.0778
 Fax: 859.283.2978 www.postglover.com
 COPYRIGHT © 2003

TITLE/DESCRIPTION:
 ENCLOSURE, PULSER
 NEMA 3R, FREESTANDING

THIS DOCUMENT AND THE INFORMATION IT CONTAINS ARE THE PROPERTY OF POST GLOVER RESISTORS INC. IT IS DISCLOSED IN CONFIDENCE AND MAY NOT BE REPRODUCED, USED OR DISCLOSED EXCEPT FOR THE PURPOSE FOR WHICH IT IS FURNISHED WITHOUT PRIOR WRITTEN CONSENT.
 UNLESS OTHERWISE SPECIFIED (U.O.S.), TOLERANCES PER ASSEMBLY DRAWING #47849, AND ALL DIMENSIONS IN INCHES.

DATE: 10/13/03	ENGR: CCH	CHECKED	APPROVED
SCALE: N/A	DFTR: JDB		

TOLERANCES ARE AS FOLLOWS U.O.S. ±
 .X = .05 .XX = .01 .XXX = .005 .XXXX = .0005 FRAC = 1/32

SHEET: 1 OF 1	DRAWING NUMBER	REVISION
PLSENCMYF03		00

A B C D E F G H